

Watsons Bay (Wentworth Mausoleum) Leasing Ordinance 1992

No 53, 1992

An Ordinance to authorise the leasing of certain land at Vacluse and for matters incidental thereto.

Whereas

- A. The Property Trust is the registered proprietor of the land ("Mausoleum Land") described in the First Schedule on which is constructed the Wentworth Mausoleum.
- B. The Property Trust is the registered proprietor of the land ("Church Land") described in the Second Schedule on which is constructed the Wentworth Memorial Church.
- C. The Mausoleum Land and the Church Land are both church trust property held on trust for the Parish of Watsons Bay although no trusts have been declared in writing.
- D. The Historic Houses Trust of New South Wales ("Trust") wishes to take a lease of the Mausoleum Land and a lease of part of the Church Land for a term of 99 years.
- E. Due to circumstances arising since the creation of the trusts on which the Mausoleum Land and the Church Land is held it is expedient that the trusts be amended so as to permit the leasing of the Mausoleum Land and part of the Church Land to the Trust.

Now the Standing Committee of the Synod of the Diocese of Sydney in the name and place of the said Synod Hereby Ordains Declares Directs and Rules as follows.

1. This ordinance may be cited as the "Watsons Bay (Wentworth Mausoleum) Leasing Ordinance 1992".
2. By reason of circumstances which have arisen subsequent to the creation of the trusts upon which the Mausoleum Land and the Church Land is held it is inexpedient to carry out and observe the same to the extent that they are hereby varied and it is expedient that the Mausoleum Land and that part of the Church Land described in the Third Schedule be leased in the manner set out in this ordinance (with such rights of access thereto over such part or parts of the residue of the Church Land as to the Property Trust seems appropriate).
3. The Property Trust is authorised to lease the Mausoleum Land and that part of the Church Land described in the Third Schedule to the Trust for a term of 99 years and at an annual rental of \$1 per annum and on such other terms as may seem appropriate to the Property Trust.
4. The receipts of any lease authorised by this ordinance must be paid to the churchwardens of Wentworth Memorial Church Vacluse to be applied by them for such purposes of the Parish of Watsons Bay as the Parish Council of the Parish may by resolution determine.

First Schedule

The land situated at Vacluse in the Municipality of Woollahra, Parish of Alexandria and County of Cumberland being lot 2 in deposited plan 180729 and being the land described in Conveyance Registered Book 1493 Number 557.

Second Schedule

The land situated at Vacluse in the Municipality of Woollahra, Parish of Alexandria and County of Cumberland being lot 1 in deposited plan 180729 and being the land comprised in Folio Identifier 1/180729.

Third Schedule

The part of the church land included in lot 1 on the plan prepared by Peter French Surveyors reference 86-1828-A a copy of which is annexed.

Watsons Bay (Wentworth Mausoleum) Leasing Ordinance 1992

I Certify that the Ordinance as printed is in accordance with the Ordinance as reported.

E.D. Cameron
Deputy Chairman of Committees

I Certify that this Ordinance was passed by the Standing Committee of the Synod of the Diocese of Sydney on the 14th day of December 1992.

W.G.S. Gotley
Secretary

I Assent to this Ordinance.

Donald Robinson
Archbishop of Sydney
22/12/1992

CHAPEL ROAD

FITZMILLIAM ROAD

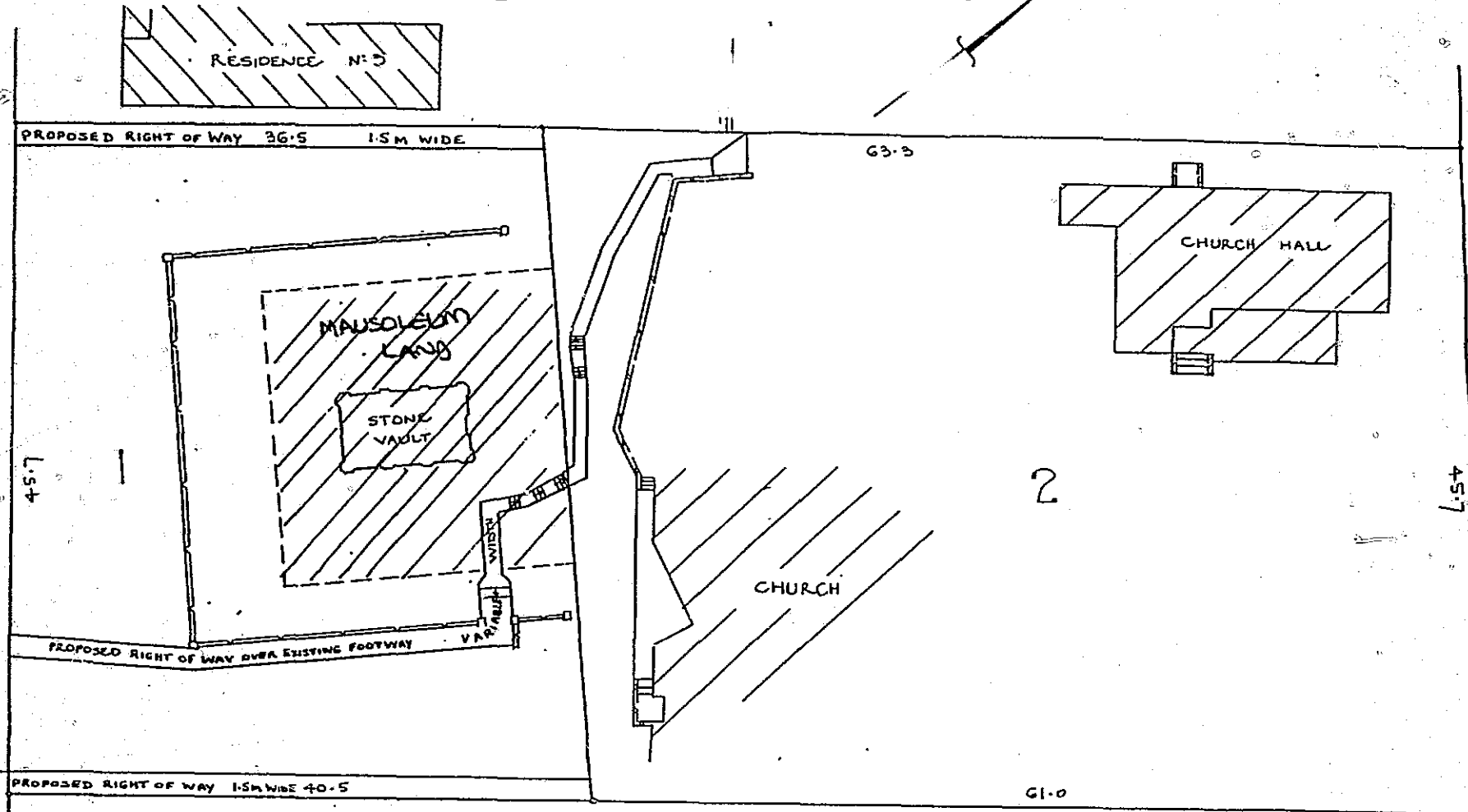

NOTE: DIMENSIONS ON THIS DRAWING SUBJECT TO SURVEY

			PROJECT: WENTWORTH MEMORIAL VAUCLUSE.	DETAILS: PROPOSED SUBDIVISION FOR LEASE PURPOSES	SCALE: 1: 1	REFERENCE 86-1828-A	PETER FRENCH SURVEYORS CORRESPONDENCE TO: P.O. BOX 164 KINGS CROSS 201 OR. DX. 1510 SYDNEY.
DATE	DWG No	ISSUE/REVISION	MUNICIPALITY OF WOOLLAHRA		DIMENSIONS IN METRES	DRAWING No. 1A	
30-3-89	1A	Amended by M.S.F. MR. BUESSE					
14-11-88	1						

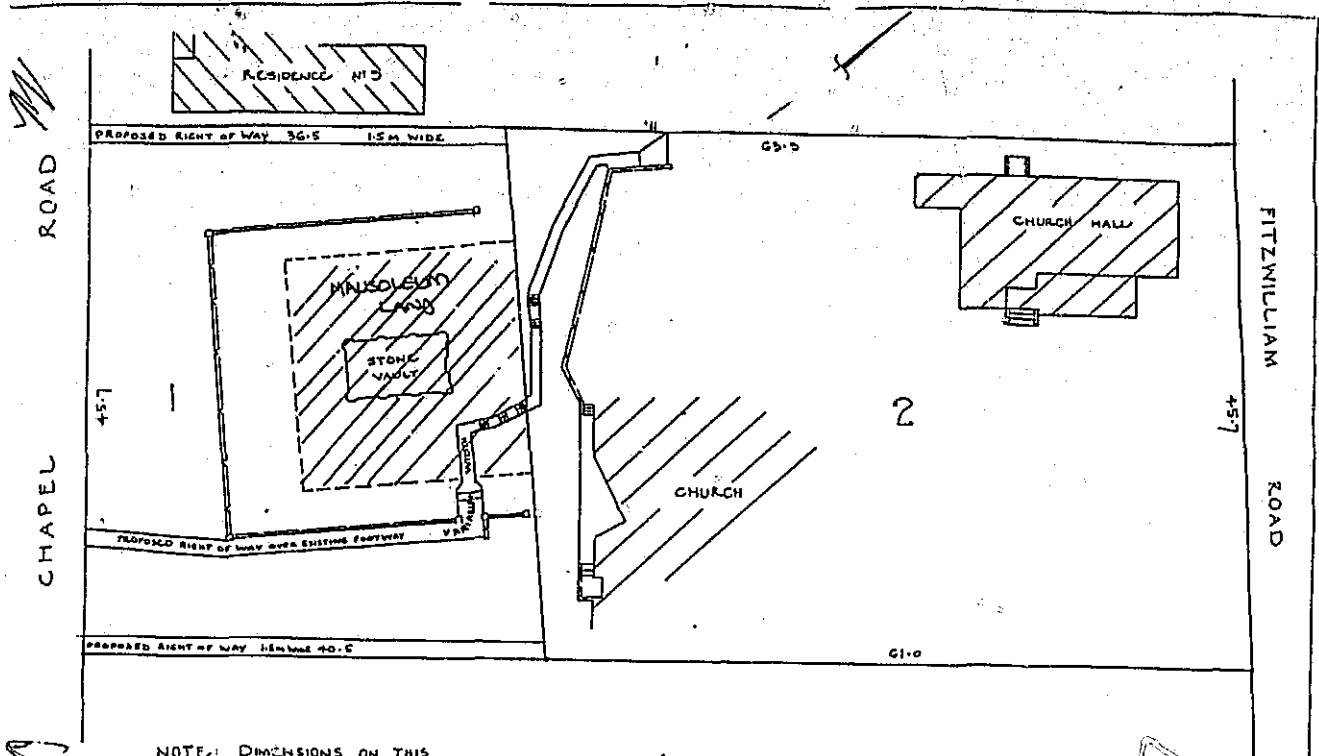

NOTE: DIMENSIONS ON THIS DRAWING SUBJECT TO SURVEY

			PROJECT: WENTWORTH MEMORIAL VAUCLUSE. MUNICIPALITY OF NOOLBARRA	DETAILS: PROPOSED SUBDIVISION FOR LEASE PURPOSES	SCALE: 1: DATUM: DIMENSIONS IN METRES Fm. L.B.	REFERENCE: 86-1828-A DRAWING No. 1.A	PETER FRENCH SURVEYORS CORRESPONDENCE TO: P.O. BOX 164 KINGS CROSS 2011 OR DR. 1510 SYDNEY. TELEPHONE 206-2656
30-3-86	1.A	Amended by 1A 32 of 2012/13					
DATE	DWG No	ISSUE/REVISION					